

F1021M

ULTRA RECEPTACLE

32-gallon expanded steel receptacle
with contour top and liner

Replacement Parts

Contour Top	F3005
Black Plastic Liner	F1017

Accessories

Trad. Inground Mount	F1094
Trad. Surface Mount	F1098
45° Surface Mount	F1406
45° Inground Mount	F1407
Corkscrew Anchor	A1020

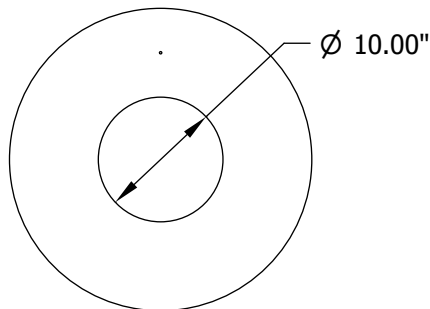

TOP VIEW

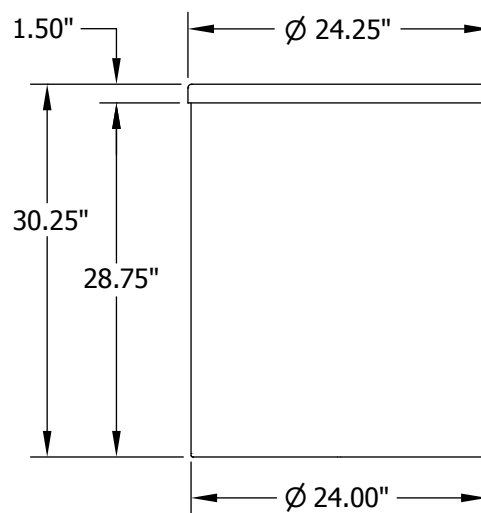

SIDE VIEW

Material

The 32-gallon receptacle body is made of 3/4 #9 expanded steel with a diamond pattern. The receptacle is protected by Fusion Advantage™, a plastisol coating with an average .125" thickness and a high-gloss powder coat.

The contour top is made of 18-gauge galvanized steel protected with a high-gloss powder coat finish. The top features a 10" diameter center opening for easy waste disposal and includes a 14" web security strap.

The reusable 32-gallon plastic liner is made of black high-density polyethylene.

Options and Accessories

Optional mounting kits for various applications are available.

Finish

Fusion Advantage is a heat fused plastisol coating that creates an impervious rustproof barrier and resists UV deterioration, mildew, staining and fading.

The finish has been tested to the requirements of ASTM E1354 and is determined to be in compliance with California Uniform Fire Code 1103.2.1.4.2.

Color

See website or sales representative for color choices.

Assembly

Attachment of the top to the receptacle body requires some assembly. Mounting options require assembly also, if purchased.

Maintenance

The product is virtually maintenance-free and requires only periodic cleaning with a sponge and a solution of mild detergent and water to remove surface dirt. Do not clean with solvent or petroleum based products.

Warranty

20-year limited structural warranty with 7-year finish warranty from the date of purchase. See full details on multi-year warranties for components at www.anovafurnishings.com/warranty.aspx.

Shipping Information

Unit Wt.	Unit Shipping Wt. UPS (1 Unit)	Unit Shipping Wt. Truck (2+ Units)	Unit Ship Size w/Pallet	Max Units per Pallet	Pallet Wt. (48" x 48")	Total No. Pkgs	Shipping Class
71 lbs	110 lbs/unit	83 lbs/unit	32 cu. ft.	8	50 lbs	1	150

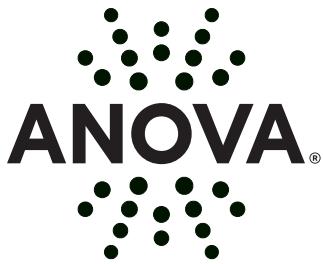

211 North Lindbergh Blvd.
St. Louis, MO 63141
800.231.1327tel| 314.754.0835 fax
specify@anovafurnishings.com
anovafurnishings.com

F1098- Surface Mount Kit for Receptacles

Steel surface mount plate for receptacles

Material

The 8" square mounting plate is made of .19" thick sheet steel and is designed to bolt to the base of a 30- or 32-gallon receptacle and an existing surface. Surface mount plate raises the receptacle 5.38" off the ground. Mounting plate has predrilled .50" diameter holes for surface mounting to prevent movement.

Surface mounting is required; mounting hardware is not included.

Finish

Fade-resistant powder coated steel components feature a state-of-the art primer proven to prevent rusting. Treated components exceed the industry standard by 34% in testing by independent sources.

Color

See website or sales representative for color choices.

Assembly

The mounting kit requires some assembly. Stainless steel assembly hardware is included.

Maintenance

The product is virtually maintenance-free and requires only periodic cleaning with a sponge and a solution of mild detergent and water to remove surface dirt. Do not clean with solvent or petroleum base products.

Warranty

20-year limited structural warranty with 7-year finish warranty against fading from date of purchase. See full details on multi-year warranties for components at www.anovafurnishings.com/warranty.aspx.



Designed to accommodate the following products:

F1021D 32-Gal expanded dome receptacle
F1021L 32-Gal expanded receptacle base
F1021M 32-Gal expanded contour receptacle
D1021D 32-Gal perforated dome receptacle
D1021L 32-Gal perforated receptacle base
D1021M 32-Gal perforated contour receptacle
L1336D 32-Gal slotted dome receptacle
L1336L 32-Gal slotted receptacle base
L1336M 32-Gal slotted contour receptacle
F3200 23-Gal expanded ash top receptacle

Call about Rendezvous, Recycled, and Rally lines.

