



CITY OF DORAL
 PUBLIC WORKS DEPARTMENT
 8401 NW 53rd Terrace
 DORAL, FLORIDA 33166
 Ph. (305)593-6740
 Fax (305) 593-6617

WORK AUTHORIZATION FOR CONTRACTUAL SERVICES

TO: H & R Paving, Inc.
 1955 NW 110th Avenue
 Miami, FL 33172
 305-261-3005
 305-592-6079 FAX

DATE: January 10, 2018

WORK ORDER No. 17-06 (ITB #2016-43)

TOTAL AMOUNT: \$342,523.79 (Not to exceed)

PROJECT SCOPE OF WORK: The City of Doral authorizes the firm of H&R Paving, Inc. to proceed with milling, resurfacing, road striping, and sidewalk construction as per the attached roadway plan description. Work is to be performed along the following road segments, NW 112th Ave. from NW 87th St. to NW 90th St., NW 112th Ave. from NW 82nd St. to NW 86th St., NW 112th Ct. from NW 82nd St. to NW 112th Ave., NW 86th St. from NW 107th Ave. to NW 109th Ave., NW 50th St. from NW 114th Ave. to NW 117th Ave. and NW 50th St. from NW 109th Ave. to NW 112th Ave., as provided by the City's Public Works Department, in accordance with the terms, conditions and specifications of the Contract Documents, (ITB#2016-43) "Milling and Resurfacing of Bituminous Paving, Miscellaneous Stormwater Improvement" Agreement. All road construction and repairs will comply with Miami-Dade County Public Works Manual Part 2 Design and Construction Section 51, Limerock Base, Section 100, Prime and Tack Coats, Section 132, Asphaltic Concrete Binder Course, Section 133, Type S-I Asphaltic Concrete Surface Course.

If Contractor fails to execute said Work Order in a timely manner and complete all work within 30 calendar days from the time this work order is executed. The City of Doral will be entitled to disqualify the Proposal, and revoke the award.

The performance of services associated with this Work Order will be executed on a 'Line Item' basis with a not to exceed amount of \$342,523.79, which includes a 10% contingency.

Contractor: H & R Paving, Inc.

WITNESSES: SEAL:

BY: [Signature]
 NAME: Abe Rodriguez
 TITLE: _____

1. _____
 2. _____

OWNER: City of Doral
 BY: [Signature]
 NAME: Edward Rojas
 TITLE: City Manager

AUTHENTICATION:
 BY: [Signature]
 NAME: Connie Diaz
 TITLE: City Clerk

APPROVED AS TO FORM AND
 LEGAL SUFFICIENCY FOR THE SOLE USE
 OF THE CITY OF DORAL:

BY: [Signature]
 NAME: Weiss, Serota, Helfman,
 Cole & Bierman, PL
 TITLE: City Attorney

Item	Description	Unit	QTY	Unit Price	Cost
1	Mobilization-Demobilization (Emergency Repairs)(Includes dust control methods)	EA		\$ 1.00	\$ -
2	Maintenance of Traffic (Emergency Repairs)(Includes traffic control, pedestrian and vehicle access, signs, barricades, and flagger, as per FDOT Standards, lighting, and steel plates if required)	EA		\$ 1.00	\$ -
3	Mobilization-Demobilization (Milling and Resurfacing Projects)(Includes dust control methods)	EA	2	\$ 1.00	\$ 2.00
4	Maintenance of Traffic (Milling and Resurfacing Projects)(Includes traffic control, pedestrian and vehicle access, signs, barricades, and flagger, as per FDOT Standards, lighting, and steel plates if required)	EA	2	\$ 450.00	\$ 900.00
5	Mobilization-Demobilization (Pavement Marking and Signage Projects)(Scope of work: existing pavement marking removal, pavement markings, rpms, etc.)	EA	2	\$ 1.00	\$ 2.00
6	Maintenance of Traffic (Pavement Marking Projects)(Includes traffic control, pedestrian and vehicle access, signs, barricades, and flagger, as per FDOT Standards, lighting, and steel plates if required)	EA	2	\$ 1.00	\$ 2.00
7	Mobilization-Demobilization (Concrete Projects)(Includes dust control methods)(Scope of work: removal of existing concrete features, installation of new concrete features)	EA	2	\$ 1.00	\$ 2.00
8	Maintenance of Traffic (Concrete Projects)(Includes traffic control, pedestrian and vehicle access, signs, barricades, and flagger, as per FDOT Standards, lighting, and steel plates if required)	EA	2	\$ 450.00	\$ 900.00
9	Mobilization-Demobilization (Stormwater Improvements Project)(Includes dust control methods)(Scope of work: repairs of existing features, installation of new features)	EA		\$ 1.00	\$ -
10	Maintenance of Traffic (Stormwater Improvements Project)(Includes traffic control, pedestrian and vehicle access, signs, barricades, and flagger, as per FDOT Standards, lighting, and steel plates if required)	EA		\$ 450.00	\$ -
11	Remove existing Sidewalk (4" thick, 6" thick at driveways)(Includes removal of handicap ramps, meter/valve box adjustment, and disposal of materials)	SF	1,880	\$ 2.00	\$ 3,760.00
12	Construct new sidewalk (4" thick, 6" thick at driveway)(Includes cut and fill, sub-grade prep., ADA compliant handicap ramps, etc.)	SF	1,880	\$ 4.50	\$ 8,460.00
13	Curb Ramp Detectable Warning Surface (to install on ADA compliant curb ramp)	SF		\$ 25.00	\$ -
14	Root pruning under existing sidewalk (Perpendicular length of sidewalk)(Includes disposal of material)	LF		\$ 1.00	\$ -
15	Remove Existing Curb & Gutter, Valley Gutter, Traffic Separator (Includes Disposal of Material)	LF	30	\$ 5.00	\$ 150.00
16	Construct Concrete Traffic Separator	SF		\$ 10.00	\$ -
17	Construct New Type A Concrete Curb (as per FDOT Standards)(Includes sub-grade material and prep.)	LF		\$ 10.00	\$ -
18	Construct New Type B Concrete Curb (as per FDOT Standards)(Includes sub-grade material and prep.)	LF		\$ 10.00	\$ -
19	Construct New Type D Concrete Curb (as per FDOT Standards)(Includes sub-grade material and prep.)	LF		\$ 25.00	\$ -
20	Construct New Type E Median Curb (as per FDOT Standards)(Includes sub-grade material and prep.)	LF		\$ 25.00	\$ -
21	Construct New Type F Curb & Gutter (as per FDOT Standards)(Includes sub-grade material and prep.)	LF		\$ 30.00	\$ -
22	Construct New Drop Curb (as per FDOT Standards)(Includes sub-grade material and prep.)	LF	30	\$ 10.00	\$ 300.00
23	Grading of Grass Swale Area	SF		\$ 0.50	\$ -
24	Removal of Existing Drainage Structure (Includes removal and disposal of material)	EA		\$ 500.00	\$ -
25	Installation of Type P Drainage Structure	EA		\$ 3,500.00	\$ -
26	Furnish and Install Exfiltration Trench - 18" Perforated HDPE Pipe (4' wide trench)(Includes asphalt removal, excavation, backfill, sub-grade backfill material, lime rock base, disposal of excess, and trench temporary restoration)	LF		\$ 100.00	\$ -
27	Furnish and Install Exfiltration Trench - 24" Perforated HDPE Pipe (4' wide trench)(Includes asphalt removal, excavation, backfill, sub-grade backfill material, lime rock base, disposal of excess, and trench temporary restoration)	LF		\$ 110.00	\$ -
28	Furnish and Install 15" Solid-Wall HDPE Pipe (Includes asphalt removal, excavation, backfill, sub-grade backfill material, lime rock base, disposal of excess, and trench temporary restoration)			\$ 50.00	\$ -
29	Furnish and Install 18" Solid-Wall HDPE Pipe (Includes asphalt removal, excavation, backfill, sub-grade backfill material, lime rock base, disposal of excess, and trench temporary restoration)	LF		\$ 50.00	\$ -
30	Furnish and Install 24" Solid-Wall HDPE Pipe (Includes asphalt removal, excavation, backfill, sub-grade backfill material, lime rock base, disposal of excess, and trench temporary restoration)	LF		\$ 50.00	\$ -
31	Core Drill, Tie & Seal to Existing Drainage Structure	EA		\$ 200.00	\$ -
32	Furnish and Install Pollution Baffles / Skimmer	EA		\$ 200.00	\$ -

33	Furnish and Install Sediment Barrier (Silt Fence)	LF		\$ 1.00	\$ -
34	Adjust Manhole	EA	6	\$ 1.00	\$ 6.00
35	Adjust Valve Boxes	EA	29	\$ 1.00	\$ 29.00
36	Seal Existing Pipe Connections	EA		\$ 50.00	\$ -
37	Flowable Fill	CY		\$ 150.00	\$ -
38	Regular Excavation	CY		\$ 1.00	\$ -
39	Embankment	CY		\$ 1.00	\$ -
40	Type B Stabilization	CY		\$ 2.00	\$ -
41	Rework Limerock Base, 3"	SY		\$ 2.00	\$ -
42	Optional Base, Base Group 6	SY		\$ 18.00	\$ -
43	Optional Base, Base Group 11	CY		\$ 20.00	\$ -
44	Coral Rock Limerock LBR 40	TN		\$ 20.00	\$ -
45	Milling Existing Asphalt Pavement, 1" Ave. Depth	SY	30,946	\$ 2.00	\$ 61,892.00
46	Milling Existing Asphalt Pavement, 2" Ave. Depth	SY		\$ 0.50	\$ -
47	Asphalt Leveling Course	TN		\$ 80.00	\$ -
48	Superpave Asphaltic Concrete, Traffic B, SP-9.5	TN	1,702	\$ 110.50	\$ 188,071.00
49	2" S-3 Bituminous Overlay	TN		\$ 100.00	\$ -
50	Exploratory Excavation: JD310 or Equal w/Operator	HR		\$ 40.00	\$ -
51	Exploratory Excavation: JD310 or Equal w/Operator	CY		\$ 1.00	\$ -
52	Exploratory Excavation: 2-man Labor Crew	HR		\$ 40.00	\$ -
53	Exploratory Excavation: 2-man Labor Crew	CY		\$ 1.00	\$ -
54	Furnish and Install Sod	SY		\$ 5.00	\$ -
55	Tree Relocation Specimen (Tree Trunk diameter < 12 in., DBH)	EA		\$ 850.00	\$ -
56	Tree Relocation Specimen (Tree Trunk diameter > 12 in., DBH)	EA		\$ 1,500.00	\$ -
57	Existing Thermoplastic Striping/Markings Removal	SF		\$ 2.40	\$ -
58	Retro-reflective Pavement Markers (yellow)	EA	792	\$ 3.60	\$ 2,851.20
59	Retro-reflective Pavement Markers (white)	EA	131	\$ 3.60	\$ 471.60
60	Retro-reflective Pavement Markers (blue)	EA	4	\$ 3.60	\$ 14.40
61	Painted Pavement Marking, Standard, White, Solid, 6"	EA	9,772	\$ 0.24	\$ 2,345.28
62	Painted Pavement Marking, Standard, White, Solid, 8"	EA	446	\$ 0.96	\$ 428.16
63	Painted Pavement Marking, Standard, White, Solid, 12"	LF	674	\$ 0.96	\$ 647.33
64	Painted Pavement Marking, Standard, White, Solid, 18"	LF	455	\$ 1.20	\$ 546.00
65	Painted Pavement Marking, Standard, White, Solid, 24"	LF	401	\$ 1.20	\$ 481.20
66	Painted Pavement Marking, Standard, White, Skip, 6" (10'-30')	LF	4,468	\$ 0.24	\$ 1,072.32
67	Painted Pavement Marking, Standard, White, Dotted/Guideline/6-10 GAP, Ext 6"	LF		\$ 0.24	\$ -
68	Painted Pavement Markings, Standard, White, Message	EA	2	\$ 36.00	\$ 72.00
69	Painted Pavement Markings "SHARROW" and Bicycle Pavement Markings	EA		\$ 360.00	\$ -
70	Painted Pavement Markings, Standard, White, Arrow	EA	14	\$ 24.00	\$ 336.00
71	Painted Pavement Marking, Standard, Yellow, Solid, 6"	LF	11,341	\$ 0.24	\$ 2,721.84
72	Painted Pavement Marking, Standard, Yellow, Solid, 18"	LF	1,071	\$ 0.96	\$ 1,028.16
73	Painted Pavement Marking, Standard, Yellow, Skip, 6" (10'-30')	LF	2,012	\$ 0.24	\$ 482.88
74	Painted Pavement Marking, Standard, Yellow, Skip, 6" (2'-4')	LF		\$ 1.20	\$ -
75	Thermoplastic, Standard, White, Solid, 6"	LF	9,772	\$ 0.84	\$ 8,208.48
76	Thermoplastic, Standard, White, Solid, 8"	LF	446	\$ 1.20	\$ 535.20
77	Thermoplastic, Standard, White, Solid, 12"	LF	674	\$ 2.04	\$ 1,375.57
78	Thermoplastic, Standard, White, Solid, 18"	LF	455	\$ 3.60	\$ 1,638.00
79	Thermoplastic, Standard, White, Solid, 24"	LF	401	\$ 3.60	\$ 1,443.60
80	Thermoplastic, Standard, White, Skip, 6" (10'-30')	LF	4,468	\$ 0.84	\$ 3,753.12
81	Thermoplastic, Standard, White, Dotted/Guideline/6-10 GAP, Ext 6"	LF		\$ 1.14	\$ -
82	Thermoplastic, Standard, White, Message	EA	2	\$ 144.00	\$ 288.00
83	Thermoplastic "SHARROW" and Bicycle Pavement Markings	EA		\$ 360.00	\$ -
84	Thermoplastic, Standard, White, Arrow	EA	14	\$ 72.00	\$ 1,008.00
85	Thermoplastic, Standard, Yellow, Solid, 6"	LF	11,341	\$ 0.84	\$ 9,526.44
86	Thermoplastic, Standard, Yellow, Solid, 18"	LF	1,071	\$ 3.60	\$ 3,855.60
87	Thermoplastic, Standard, Yellow, Skip, 6" (10'-30')	LF	2,012	\$ 0.84	\$ 1,690.08
88	Thermoplastic, Standard, Yellow, Skip, 6" (2'-4')	LF		\$ 1.14	\$ -
89	Reflective Paint (Island Nose) Yellow	SF	37	\$ 2.40	\$ 88.80
90	Patterned Pavement, Vehicular Areas - Green Bike Lane (FDOT Item No. 0523-1-3)	SY		\$ 30.25	\$ -
91	Single Sign Post, F&I	EA		\$ 360.00	\$ -
92	Replace Existing Traffic Loop	EA		\$ 1,800.00	\$ -
93	Off-Duty Police Officer	HR		\$ 60.00	\$ -

Subtotal	\$ 311,385.26
10% Contingency	\$ 31,138.53
Total	\$ 342,523.79

MAYOR AND CITY COUNCIL:

Mayor
Luigi Boria
Vice Mayor
Christi Fraga
Councilman
Pete Cabrera
Councilwoman
Ana Maria Rodriguez
Councilwoman
Sandra Ruiz

CITY OF DORAL
PUBLIC WORKS DEPARTMENT

MILLING AND RESURFACING EXHIBITS
SEGMENTS 1, 2, 3, 4, 6 & 7

CITY OF DORAL, FLORIDA

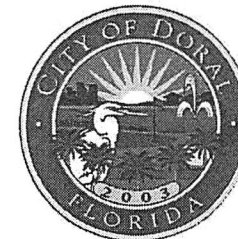

INDEX OF ROADWAY PLAN DESCRIPTION

<u>SHEET NO.</u>	<u>SHEET DESCRIPTION</u>
1	KEY SHEET
2	GENERAL NOTES
3	TABULATION OF QUANTITIES
4	SEGMENT 1 NW 112TH AVENUE FROM NW 87TH STREET TO NW 90TH STREET
5-6	SEGMENT 2 NW 112TH AVENUE FROM NW 82ND STREET TO NW 86TH STREET
7	SEGMENT 3 NW 112TH COURT FROM NW 82ND STREET TO NW 112TH AVENUE
8	SEGMENT 4 NW 86TH STREET FROM NW 107TH AVENUE TO NW 109TH AVENUE
9	SEGMENT 6 NW 50TH STREET FROM NW 114TH AVENUE TO NW 117TH AVENUE
10	SEGMENT 7 NW 50TH STREET FROM NW 109TH AVENUE TO NW 112TH AVENUE
11	MISCELLANEOUS DETAILS

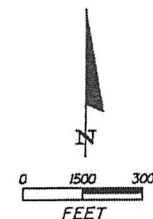
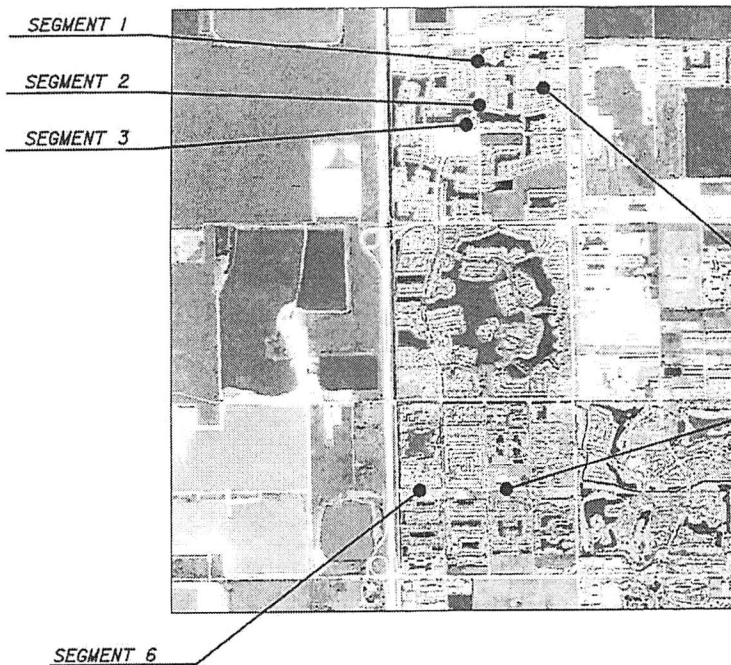

Professional Engineer Seal for Jose Antonio Otero, No. 78490, State of Florida. Includes a date stamp: AUG 17 2016 and a '911' logo with the text 'BEFORE YOU DIG'.

PLANS PREPARED BY:



6401 SW 87th Ave, Suite 200
Miami, Florida 33173
Phone: (305) 670-2350
Fax: (305) 670-2351
Certificate of Authorization No. 7184

NOTE: THE SCALE OF THESE PLANS MAY HAVE CHANGED DUE TO REPRODUCTION.

ROADWAY PLANS
ENGINEER OF RECORD: JOSE A. OTERO, P.E.

FLORIDA LICENSE NO.: 78490

JORGE A. GOMEZ, P.E., DIRECTOR OF PUBLIC WORKS

SHEET NO.
1

24. THE CONTRACTOR SHALL PREPARE AND SUBMIT SHOP DRAWINGS FOR ALL ITEMS AND MATERIALS USED IN THIS PROJECT.

25. THE CONTRACTOR SHALL INSTALL BLUE PIPES IN THE CENTER OF THE OUTERMOST TRAVEL LANE DIRECTLY PERPENDICULAR TO EACH EXISTING FIRE HYDRANT.

26. THE CONTRACTOR SHALL BE CAUTIOUS DURING MILLING ACTIVITIES SO AS TO LEAVE $\frac{1}{2}$ EXISTING ASPHALT MINIMUM.

27. THE CONTRACTOR SHALL COPY WITH THE CITY OF DORAL GUIDELINES FOR REMOVED/REPAVED ASPHALT CONCRETE.

28. CONTRACTOR SHALL MILL AND RESURFACE THE EDGES/UNITS USING THE RESURFACING DETAIL INCLUDED ON SHEET NO. 15.

29. EXISTING DRAINAGE STRUCTURES WITHIN THE CONSTRUCTION UNITS SHALL REMAIN UNLESS OTHERWISE NOTED.

30. THE CONTRACTOR SHALL BE RESPONSIBLE FOR MAINTAINING EXISTING DRAINAGE STRUCTURES/PRESERVE CLEAN AND FREE OF DEBRIS THROUGHOUT THE PROJECT DURATION. PRIOR TO THE SUBSTITUTION VALVE/THROUGH THE CONTRACTOR SHALL ENSURE THAT ALL EXISTING DRAINAGE STRUCTURES/PRESERVE HAVE BEEN THOROUGHLY CLEANED OF ALL DEBRIS, SILT, SEDIMENT, VEGETATION, MILLING MATERIAL, ETC.

31. ALL EXISTING UTILITIES ARE TO REMAIN UNLESS OTHERWISE NOTED. ALL EXISTING UTILITIES SHALL BE MAINTAINED IN SERVICE DURING CONSTRUCTION UNLESS OTHERWISE APPROVED BY THE UTILITY OWNER.

32. THE CONTRACTOR IS TO USE CAUTION WHEN WORKING IN OR AROUND AREAS OF OVERHEAD OR UNDERGROUND POWER LINES. IT SHALL BE THE CONTRACTOR'S RESPONSIBILITY TO COORDINATE WITH FPL OR ANY WORK IN THE VICINITY OF OVERHEAD OR UNDERGROUND POWER LINES. PROPER CLEARANCES SHALL BE VERIFIED PRIOR TO WORKING WITHIN THE VICINITY OF POWER LINES.

33. TWO FULL BUSINESS DAYS PRIOR TO COMMENCING WORK THE CONTRACTOR SHALL CALL SINGHERS AND THE UTILITY OWNER AND REQUEST UTILITY LOCATIONS. A CONTRACTOR'S REPRESENTATIVE MUST BE PRESENT WHEN UTILITY COMPANIES LOCATE THEIR FACILITIES.

34. TWO FULL BUSINESS DAYS PRIOR TO COMMENCING WORK THE CONTRACTOR SHALL NOTIFY THE CITY OF DORAL FOR COORDINATION PURPOSES.

35. ALL PULL BOXES, MANHOLES, VALVE BOXES, ETC., SHALL BE ADJUSTED MEETING THE UTILITY OWNERS REQUIREMENTS/Criteria.

36. CONTRACTOR SHALL COORDINATE WORK WITH EACH UTILITY OWNER PRIOR TO CONSTRUCTION.

37. THE CONTRACTOR SHALL ADJUST ALL EXISTING MANHOLE TOPS, INLET GRATINGS, VALVE BOX TOPS, WATER METER TOPS, AND PULL BOX TOPS WITHIN THE PROJECT AREA TO MATCH THE PROPOSED FINISHED GRADE IN ACCORDANCE TO THE UTILITY OWNERS REQUIREMENTS/Criteria. THE PROJECT PLANS MAY NOT REFLECT ALL LOCATIONS WHERE ADJUSTMENTS ARE NECESSARY. THE CONTRACTOR IS RESPONSIBLE FOR LOCATING ALL NECESSARY UTILITY LOCATIONS AND RECORDING THE ADJUSTMENTS AS REQUIRED, AS WELL AS, FOR COORDINATING WITH EACH UTILITY OWNER PRIOR TO PERFORMING WORK.

38. THE CONTRACTOR SHALL BE RESPONSIBLE FOR REMOVING ALL UTILITY MARKINGS ONCE THE WORK IS COMPLETED. THE CONTRACTOR SHALL USE SPECIAL CARE WHEN REMOVING THE UTILITY MARKINGS. THE REMOVAL METHOD NEEDS TO BE SUCH THAT IT DOES NOT DAMAGE THE SURFACE OF THE WORK ALREADY IN PLACE. IF HAND-APPLIED ASPHALT PAVEMENT CARE NEEDS TO BE TAKEN TO REPAIR THE ASPHALT OR POLISH THE ASPHALT TO SHOW UNIFORM COLOR THROUGHOUT THAT SAME PANEL OR SECTION. IN ANY CASE (ASPHALT OR CONCRETE SURFACE), THE METHOD NEEDS TO BE SUCH THAT A SLICK SURFACE IS NOT LEFT BEHIND. FINAL PAVEMENT TO THE CONTRACTOR MAY BE WITHHELD UNTIL THE UTILITY WORKS ARE PROPERLY REMOVED.

39. THE CONTRACTOR SHALL NOTIFY THE UTILITY COMPANIES IN THE AREA OF WORK AT LEAST 48 HOURS PRIOR TO COMMENCING CONSTRUCTION.

40. KNOWN UTILITY COMPANIES WITHIN THE PROJECT UNITS INCLUDE, BUT ARE NOT LIMITED TO:

FLORIDA POWER & LIGHT
 ART DISTRIBUTION
 STEVE LOTT
 HARGO ESCOBAR
 LEONARD KAYWELL-NEWBOLD
 FLORIDA CITY GAS
 LEVEL 3 COMMUNICATIONS LLC
 MAIN-DRADE COUNTY PUBLIC WORKS AND TRAFFIC
 FPL FIBERNET LLC
 SYSTEMS INTEGRATION AND MAINTENANCE INC
 DANAH WASKETT
 OCTOBER WALKER
 MICHAEL COLLIER
 FLORIDA DEVELOPMENT COMPANY-FLORIDA STA
 HOMEWORK COMMUNICATIONS
 PHIL GALLUB
 JOE SOTO
 TOWN OF MEDLEY UTILITIES DEPARTMENT
 THE CITY OF DORAL PUBLIC WORKS DEPARTMENT A STORM WATER POLLUTION PREVENTION PLAN ACCORDING TO THE LATEST FLORIDA STORM WATER EROSION AND BRIDGE CONSTRUCTION. THE CONTRACTOR SHALL IMPLEMENT THE MANUAL AND THE LATEST FOOT SPECIFICATIONS FOR ROAD AND BRIDGE CONSTRUCTION. THE CONTRACTOR SHALL IMPLEMENT THE EROSION AND SEDIMENTATION CONTROL NOTES:
 (785) 28-9113
 (785) 28-9114
 (785) 28-9115
 (785) 28-9116
 (785) 28-9117
 (785) 28-9118
 (785) 28-9119
 (785) 28-9120
 (785) 28-9121
 (785) 28-9122
 (785) 28-9123
 (785) 28-9124
 (785) 28-9125
 (785) 28-9126
 (785) 28-9127
 (785) 28-9128
 (785) 28-9129
 (785) 28-9130
 (785) 28-9131
 (785) 28-9132
 (785) 28-9133
 (785) 28-9134
 (785) 28-9135
 (785) 28-9136
 (785) 28-9137
 (785) 28-9138
 (785) 28-9139
 (785) 28-9140
 (785) 28-9141
 (785) 28-9142
 (785) 28-9143
 (785) 28-9144
 (785) 28-9145
 (785) 28-9146
 (785) 28-9147
 (785) 28-9148
 (785) 28-9149
 (785) 28-9150
 (785) 28-9151
 (785) 28-9152
 (785) 28-9153
 (785) 28-9154
 (785) 28-9155
 (785) 28-9156
 (785) 28-9157
 (785) 28-9158
 (785) 28-9159
 (785) 28-9160
 (785) 28-9161
 (785) 28-9162
 (785) 28-9163
 (785) 28-9164
 (785) 28-9165
 (785) 28-9166
 (785) 28-9167
 (785) 28-9168
 (785) 28-9169
 (785) 28-9170
 (785) 28-9171
 (785) 28-9172
 (785) 28-9173
 (785) 28-9174
 (785) 28-9175
 (785) 28-9176
 (785) 28-9177
 (785) 28-9178
 (785) 28-9179
 (785) 28-9180
 (785) 28-9181
 (785) 28-9182
 (785) 28-9183
 (785) 28-9184
 (785) 28-9185
 (785) 28-9186
 (785) 28-9187
 (785) 28-9188
 (785) 28-9189
 (785) 28-9190
 (785) 28-9191
 (785) 28-9192
 (785) 28-9193
 (785) 28-9194
 (785) 28-9195
 (785) 28-9196
 (785) 28-9197
 (785) 28-9198
 (785) 28-9199
 (785) 28-9200

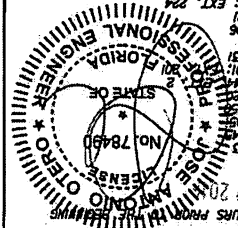

41. THE CONTRACTOR SHALL PREPARE AND SUBMIT SHOP DRAWINGS FOR ALL ITEMS AND MATERIALS USED IN THIS PROJECT.

42. THE CONTRACTOR SHALL INSTALL BLUE PIPES IN THE CENTER OF THE OUTERMOST TRAVEL LANE DIRECTLY PERPENDICULAR TO EACH EXISTING FIRE HYDRANT.

43. THE CONTRACTOR SHALL BE CAUTIOUS DURING MILLING ACTIVITIES SO AS TO LEAVE $\frac{1}{2}$ EXISTING ASPHALT MINIMUM.

44. THE CONTRACTOR SHALL COPY WITH THE CITY OF DORAL GUIDELINES FOR REMOVED/REPAVED ASPHALT CONCRETE.

45. CONTRACTOR SHALL MILL AND RESURFACE THE EDGES/UNITS USING THE RESURFACING DETAIL INCLUDED ON SHEET NO. 15.

46. EXISTING DRAINAGE STRUCTURES WITHIN THE CONSTRUCTION UNITS SHALL REMAIN UNLESS OTHERWISE NOTED.

47. THE CONTRACTOR SHALL BE RESPONSIBLE FOR MAINTAINING EXISTING DRAINAGE STRUCTURES/PRESERVE CLEAN AND FREE OF DEBRIS THROUGHOUT THE PROJECT DURATION. PRIOR TO THE SUBSTITUTION VALVE/THROUGH THE CONTRACTOR SHALL ENSURE THAT ALL EXISTING DRAINAGE STRUCTURES/PRESERVE HAVE BEEN THOROUGHLY CLEANED OF ALL DEBRIS, SILT, SEDIMENT, VEGETATION, MILLING MATERIAL, ETC.

48. ALL EXISTING UTILITIES ARE TO REMAIN UNLESS OTHERWISE NOTED. ALL EXISTING UTILITIES SHALL BE MAINTAINED IN SERVICE DURING CONSTRUCTION UNLESS OTHERWISE APPROVED BY THE UTILITY OWNER.

49. THE CONTRACTOR IS TO USE CAUTION WHEN WORKING IN OR AROUND AREAS OF OVERHEAD OR UNDERGROUND POWER LINES. IT SHALL BE THE CONTRACTOR'S RESPONSIBILITY TO COORDINATE WITH FPL OR ANY WORK IN THE VICINITY OF OVERHEAD OR UNDERGROUND POWER LINES. PROPER CLEARANCES SHALL BE VERIFIED PRIOR TO WORKING WITHIN THE VICINITY OF POWER LINES.

50. TWO FULL BUSINESS DAYS PRIOR TO COMMENCING WORK THE CONTRACTOR SHALL CALL SINGHERS AND THE UTILITY OWNER AND REQUEST UTILITY LOCATIONS. A CONTRACTOR'S REPRESENTATIVE MUST BE PRESENT WHEN UTILITY COMPANIES LOCATE THEIR FACILITIES.

51. TWO FULL BUSINESS DAYS PRIOR TO COMMENCING WORK THE CONTRACTOR SHALL NOTIFY THE CITY OF DORAL FOR COORDINATION PURPOSES.

52. ALL PULL BOXES, MANHOLES, VALVE BOXES, ETC., SHALL BE ADJUSTED MEETING THE UTILITY OWNERS REQUIREMENTS/Criteria.

53. CONTRACTOR SHALL COORDINATE WORK WITH EACH UTILITY OWNER PRIOR TO CONSTRUCTION.

54. THE CONTRACTOR SHALL ADJUST ALL EXISTING MANHOLE TOPS, INLET GRATINGS, VALVE BOX TOPS, WATER METER TOPS, AND PULL BOX TOPS WITHIN THE PROJECT AREA TO MATCH THE PROPOSED FINISHED GRADE IN ACCORDANCE TO THE UTILITY OWNERS REQUIREMENTS/Criteria. THE PROJECT PLANS MAY NOT REFLECT ALL LOCATIONS WHERE ADJUSTMENTS ARE NECESSARY. THE CONTRACTOR IS RESPONSIBLE FOR LOCATING ALL NECESSARY UTILITY LOCATIONS AND RECORDING THE ADJUSTMENTS AS REQUIRED, AS WELL AS, FOR COORDINATING WITH EACH UTILITY OWNER PRIOR TO PERFORMING WORK.

55. THE CONTRACTOR SHALL BE RESPONSIBLE FOR REMOVING ALL UTILITY MARKINGS ONCE THE WORK IS COMPLETED. THE CONTRACTOR SHALL USE SPECIAL CARE WHEN REMOVING THE UTILITY MARKINGS. THE REMOVAL METHOD NEEDS TO BE SUCH THAT IT DOES NOT DAMAGE THE SURFACE OF THE WORK ALREADY IN PLACE. IF HAND-APPLIED ASPHALT PAVEMENT CARE NEEDS TO BE TAKEN TO REPAIR THE ASPHALT OR POLISH THE ASPHALT TO SHOW UNIFORM COLOR THROUGHOUT THAT SAME PANEL OR SECTION. IN ANY CASE (ASPHALT OR CONCRETE SURFACE), THE METHOD NEEDS TO BE SUCH THAT A SLICK SURFACE IS NOT LEFT BEHIND. FINAL PAVEMENT TO THE CONTRACTOR MAY BE WITHHELD UNTIL THE UTILITY WORKS ARE PROPERLY REMOVED.

56. THE CONTRACTOR SHALL NOTIFY THE UTILITY COMPANIES IN THE AREA OF WORK AT LEAST 48 HOURS PRIOR TO COMMENCING CONSTRUCTION.

57. KNOWN UTILITY COMPANIES WITHIN THE PROJECT UNITS INCLUDE, BUT ARE NOT LIMITED TO:

FLORIDA POWER & LIGHT
 ART DISTRIBUTION
 STEVE LOTT
 HARGO ESCOBAR
 LEONARD KAYWELL-NEWBOLD
 FLORIDA CITY GAS
 LEVEL 3 COMMUNICATIONS LLC
 MAIN-DRADE COUNTY PUBLIC WORKS AND TRAFFIC
 FPL FIBERNET LLC
 SYSTEMS INTEGRATION AND MAINTENANCE INC
 DANAH WASKETT
 OCTOBER WALKER
 MICHAEL COLLIER
 FLORIDA DEVELOPMENT COMPANY-FLORIDA STA
 HOMEWORK COMMUNICATIONS
 PHIL GALLUB
 JOE SOTO
 TOWN OF MEDLEY UTILITIES DEPARTMENT
 THE CITY OF DORAL PUBLIC WORKS DEPARTMENT A STORM WATER POLLUTION PREVENTION PLAN ACCORDING TO THE LATEST FLORIDA STORM WATER EROSION AND BRIDGE CONSTRUCTION. THE CONTRACTOR SHALL IMPLEMENT THE MANUAL AND THE LATEST FOOT SPECIFICATIONS FOR ROAD AND BRIDGE CONSTRUCTION. THE CONTRACTOR SHALL IMPLEMENT THE EROSION AND SEDIMENTATION CONTROL NOTES:
 (785) 28-9113
 (785) 28-9114
 (785) 28-9115
 (785) 28-9116
 (785) 28-9117
 (785) 28-9118
 (785) 28-9119
 (785) 28-9120
 (785) 28-9121
 (785) 28-9122
 (785) 28-9123
 (785) 28-9124
 (785) 28-9125
 (785) 28-9126
 (785) 28-9127
 (785) 28-9128
 (785) 28-9129
 (785) 28-9130
 (785) 28-9131
 (785) 28-9132
 (785) 28-9133
 (785) 28-9134
 (785) 28-9135
 (785) 28-9136
 (785) 28-9137
 (785) 28-9138
 (785) 28-9139
 (785) 28-9140
 (785) 28-9141
 (785) 28-9142
 (785) 28-9143
 (785) 28-9144
 (785) 28-9145
 (785) 28-9146
 (785) 28-9147
 (785) 28-9148
 (785) 28-9149
 (785) 28-9150
 (785) 28-9151
 (785) 28-9152
 (785) 28-9153
 (785) 28-9154
 (785) 28-9155
 (785) 28-9156
 (785) 28-9157
 (785) 28-9158
 (785) 28-9159
 (785) 28-9160
 (785) 28-9161
 (785) 28-9162
 (785) 28-9163
 (785) 28-9164
 (785) 28-9165
 (785) 28-9166
 (785) 28-9167
 (785) 28-9168
 (785) 28-9169
 (785) 28-9170
 (785) 28-9171
 (785) 28-9172
 (785) 28-9173
 (785) 28-9174
 (785) 28-9175
 (785) 28-9176
 (785) 28-9177
 (785) 28-9178
 (785) 28-9179
 (785) 28-9180
 (785) 28-9181
 (785) 28-9182
 (785) 28-9183
 (785) 28-9184
 (785) 28-9185
 (785) 28-9186
 (785) 28-9187
 (785) 28-9188
 (785) 28-9189
 (785) 28-9190
 (785) 28-9191
 (785) 28-9192
 (785) 28-9193
 (785) 28-9194
 (785) 28-9195
 (785) 28-9196
 (785) 28-9197
 (785) 28-9198
 (785) 28-9199
 (785) 28-9200

1. GENERAL NOTES ON THE PROJECT PLANS AND DRAWINGS ARE SOLELY TO AID AND ASSIST THE CONTRACTOR WITH THE FIELD OPERATIONS FOR THIS PROJECT. SAID GENERAL NOTES MAY NOT FULLY DESCRIBE ALL OF THE REQUIREMENTS FOR ANY ITEM. THEREFORE, THE CONTRACTOR SHALL READ AND VERIFY THE CONTRACT DOCUMENTS, INCLUDING BUT NOT LIMITED TO THE PLANS, SPECIFICATIONS, GENERAL TERMS AND CONDITIONS, AND ANY SUPPLEMENTAL TERMS AND CONDITIONS, TO FULLY UNDERSTAND AND COMPLY WITH ALL THE REQUIREMENTS THEREIN.

2. THE INFORMATION PROVIDED ON THE PLANS IS BASED ON THE BEST AVAILABLE INFORMATION AND SHOULD BE CONSIDERED APPROXIMATE. THE CONTRACTOR SHALL BE RESPONSIBLE FOR CONDUCTING ANY AND ALL INVESTIGATIONS DEEMED NECESSARY TO CORRECT OR VERIFY ACTUAL FIELD CONDITIONS PRIOR TO BIDDING. ANY IDENTIFIED DISCREPANCIES SHALL BE REPORTED TO THE CITY OF DORAL AND THE ENGINEER OF RECORD PRIOR TO CONSTRUCTION COMMENCEMENT.

3. ALL PUBLIC LAND OWNERS AND PRIMARY NETWORK CONTROL SURVEY MONUMENTS ARE TO BE PROTECTED BY THE CONTRACTOR. CORNERS AND MONUMENTS WITHIN THE WORK ZONE AND IN DANGER OF BEING DAMAGED, DESTROYED OR COVERED SHALL BE PROPERLY REFERENCED BY A REASSISTED LAND SURVEYOR IN ACCORDANCE WITH THE MINIMUM TECHNICAL STANDARDS OF THE FLORIDA BOARD OF PROFESSIONAL LAND SURVEYORS. PRIOR TO BEGINNING WORK AT THE PROJECT SITE, IF ANY MONUMENT IS IN DANGER OF DAMAGE, THE PROJECT ENGINEER SHALL NOTIFY DAVID NEWCOMER, FLORIDA STATE GEODETIC ADVISOR MOVA/MOS/MS, 3900 COMMONWEALTH BLVD, WAIL STATION RD, TALLAHASSEE, FLORIDA 32399, TELEPHONE (904) 645-8069.

4. ANY NEW 625 BENCHMARK MONUMENT WITHIN THE LIMITS OF CONSTRUCTION ARE TO BE PROTECTED AND PROPERLY REFERENCED BY A REASSISTED LAND SURVEYOR IN ACCORDANCE WITH THE MINIMUM TECHNICAL STANDARDS OF THE FLORIDA BOARD OF PROFESSIONAL LAND SURVEYORS. PRIOR TO BEGINNING WORK AT THE PROJECT SITE, IF ANY MONUMENT IS IN DANGER OF DAMAGE, THE PROJECT ENGINEER SHALL NOTIFY DAVID NEWCOMER, FLORIDA STATE GEODETIC ADVISOR MOVA/MOS/MS, 3900 COMMONWEALTH BLVD, WAIL STATION RD, TALLAHASSEE, FLORIDA 32399, TELEPHONE (904) 645-8069.

5. ALL EXCESS MATERIAL AS DESIGNATED BY THE ENGINEER IS TO BE DISPOSED BY THE CONTRACTOR IN AREAS PROVIDED BY HIM ON A DAILY BASIS AND IN A LEGAL MANNER AT THE CONTRACTOR'S EXPENSE. ACCUMULATION OF DEBRIS OR STOCKPILING OF MATERIAL WITHIN THE PROJECT UNITS WILL NOT BE ALLOWED. ALL EXCAVATED MATERIAL SHALL BE TESTED FOR CONTAMINANTS PRIOR TO OFF-SITE DISPOSAL.

6. THE CONTRACTOR SHALL SECURE THE WORK SITE TO PROTECT THE PUBLIC HEALTH AND WELFARE.

7. THE CONTRACTOR SHALL VERIFY, PHOTOGRAPH AND IDENTIFY THE EXACT LOCATIONS OF EXISTING LANDSCAPING/TREES, STRUCTURES, PAVEMENT, FENCES OR OTHER FEATURES IN PROXIMITY TO THE WORK ZONE WHICH MAY BE IMPACTED. ANY EXISTING FENCES ARE TO BE REPAIRED OR REINSTALLED TO ORIGINAL CONDITION AT NO ADDITIONAL COST TO THE CITY.

8. ALL EXISTING FENCES ARE TO BE REPAIRED UNLESS OTHERWISE NOTED. ANY FENCE, DAMAGED BY THE CONTRACTOR AT ANY TIME DURING CONSTRUCTION UNITS, AND THE DAMAGED DURING CONSTRUCTION SHALL BE REPLACED BY THE CONTRACTOR AT NO COST. WITHIN CONSTRUCTION UNITS, ANY TREE DAMAGED DURING CONSTRUCTION SHALL BE REPLACED BY THE CONTRACTOR AT NO COST.

9. THE CONTRACTOR SHALL RESTORE ALL EXISTING SODDED AREAS OF THE PROJECT WHICH ARE DISTURBED BY THE CONSTRUCTION ACTIVITIES TO THEIR EXISTING CONDITIONS AT AN ADDITIONAL COST TO THE CITY OF DORAL.

10. THE CONTRACTOR SHALL RESTORE ALL EXISTING SODDED AREAS OF THE PROJECT WHICH ARE DISTURBED BY THE CONSTRUCTION ACTIVITIES TO THEIR EXISTING CONDITIONS AT AN ADDITIONAL COST TO THE CITY OF DORAL.

11. ALL CONSTRUCTION LAYOUT SHALL BE THE RESPONSIBILITY OF THE CONTRACTOR.

12. THE CONTRACTOR SHALL NOTIFY THE CITY AND ADJACENT PROPERTY OWNERS IN WRITING AT LEAST 48 HOURS PRIOR TO COMMENCEMENT OF CONSTRUCTION.

13. THE CONTRACTOR SHALL BE RESPONSIBLE TO SATISFY ALL REQUIREMENTS OF ANY REGULATORY AGENCY PERMIT IN REGARDS TO CONSTRUCTION.

14. THE CONTRACTOR SHALL NOT ENCROACH UPON PRIVATE PROPERTY, MATERIAL, AND/OR EQUIPMENT. ALL PROPOSED WORK SHALL BE PERFORMED WITHIN THE LIMITS OF THE EXISTING STATE/LOCAL RIGHT-OF-WAY, AND ALL IMPROVEMENTS SHALL BE CONSTRUCTED AND INSTALLED WITHIN SAID LIMITS, UNLESS OTHERWISE DIRECTED BY THE CITY OF DORAL.

15. ALL DRIVEWAYS MUST REMAIN OPEN AT ALL TIMES.

16. THE CONTRACTOR SHALL NOTIFY THE ENGINEER OF RECORD IN WRITING IMMEDIATELY IF ANY CONFLICT ARISES DURING CONSTRUCTION FOR ANY OF THE IMPROVEMENTS SHOWN IN THE PROJECT PLANS.

17. THE CONTRACTOR SHALL USE A STREET SWEEPER USING WATER OR OTHER EQUIPMENT CAPABLE OF CONTROLLING AND REMOVING DUST. APPROVAL OF THE USE OF SUCH EQUIPMENT IS CONTINGENT UPON ITS DEMONSTRATED ABILITY TO DO THE WORK.

18. THE CONTRACTOR SHALL REMOVE ALL SEWER BARRIERS AND ROCK BARS AT THE COMPLETION OF THE PROJECT.

19. THE CONTRACTOR SHALL BE RESPONSIBLE FOR THE IMMEDIATE REMOVAL OF STORMWATER FROM THE ROADWAY WITHIN THE CITY OF DORAL FOR APPROVAL BEFORE USE. THIS COST SHALL BE INCLUDED IN THE MAINTENANCE OF TRAFFIC PAY ITEM.

20. THE CONTRACTOR SHALL ASSIST THE CITY WITH THE HANDLING OF PUBLIC INFORMATION MATERIALS, INCLUDING CITIZEN NOTIFICATION LETTERS AND PROJECT CONSTRUCTION SIGNS, PRIOR TO THE START OF EACH SIGNIFICANT PHASE OF CONSTRUCTION. COST OF THIS WORK SHALL BE INCLUDED IN THE MAINTENANCE OF TRAFFIC PAY ITEM.

21. THE CONTRACTOR SHALL TAKE PHOTOS OF THE EXISTING PAVEMENT MARKINGS PRIOR TO REMOVING THEM. ALL EXISTING PAVEMENT MARKINGS REMOVED DURING CONSTRUCTION SHALL BE REPLACED BY THE CONTRACTOR.

22. WHERE NEW PAVEMENT MEETS EXISTING, THE CONNECTION SHALL BE MADE IN A HEAT STRAIGHT LINE AND FINISH WITH THE EXISTING PAVEMENT, INCLUSIVE OF ALL DRIVEWAYS LOCATIONS.

23. THE CONTRACTOR SHALL BE RESPONSIBLE FOR ENSURING THAT ALL CONSTRUCTION SHALL BE DONE IN A SAFE MANNER AND IN STRICT COMPLIANCE WITH ALL THE REQUIREMENTS OF THE FEDERAL OCCUPATIONAL SAFETY AND HEALTH ACT OF 1970, AS WELL AS, ALL STATE AND LOCAL SAFETY AND HEALTH REGULATIONS.

APPROX. MILLING AND RESURFACING AREA = 6,878 ST.

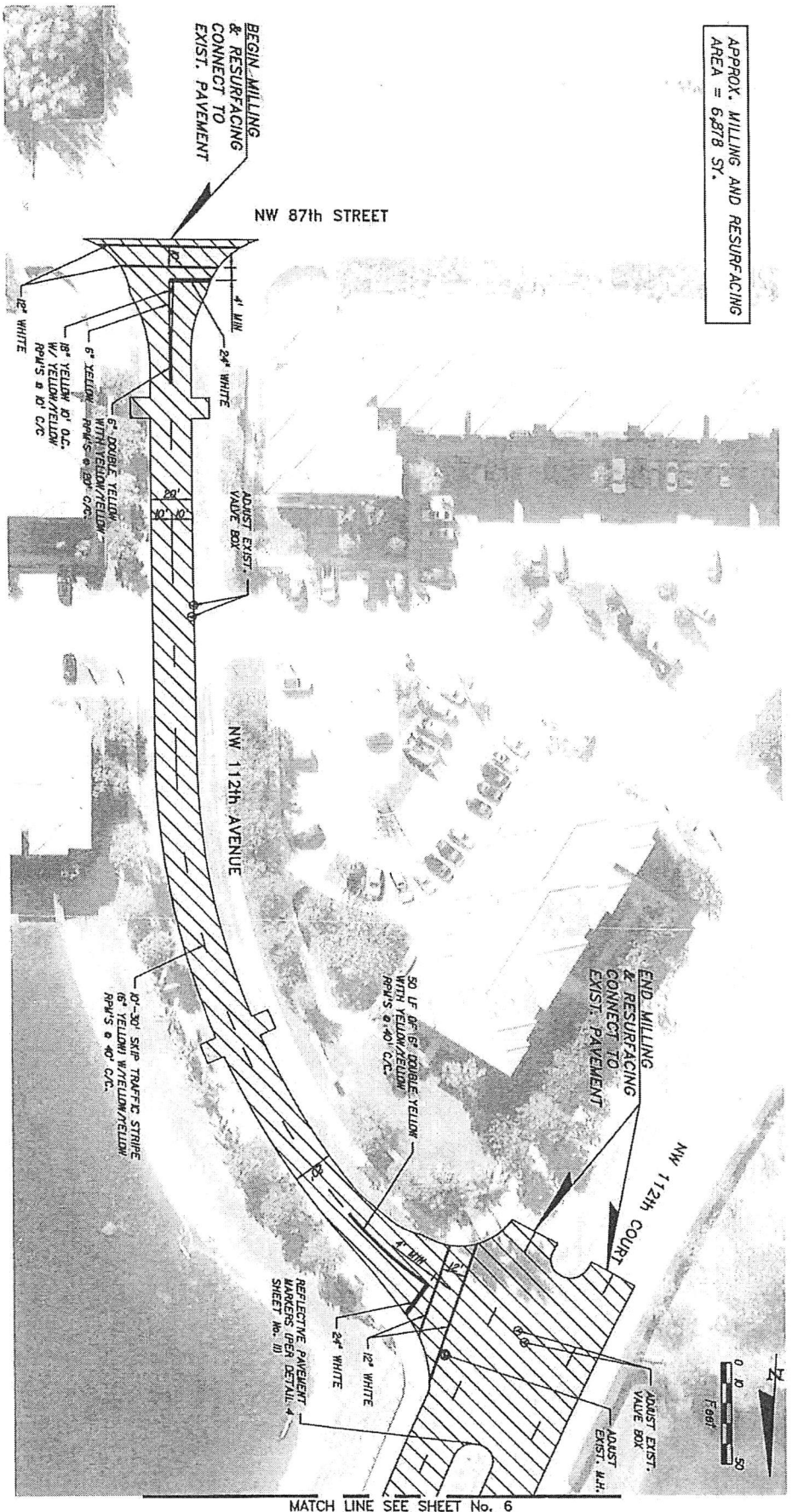

- NOTES**
1. CONTRACTOR SHALL NOTIFY ADJACENT PROPERTY OWNERS PRIOR TO COMMENCEMENT OF WORK.
 2. AN APPROVED M.O.T. PLAN SHALL BE REQUIRED ANYTIME WORK IS BEING PERFORMED AND SHOULD CONFORM TO THE LATEST EDITION OF THE FDOT WORKS SPECIFICATIONS CONCERNING THE NOTICED.
 3. CONTRACTOR SHALL FIELD VERIFY ALL EXISTING PAVEMENT SURFACES IN ACCORDANCE WITH FOOT INDEX NO. 17352.
 4. CONTRACTOR SHALL INSTALL PAVEMENT PULL BOXES FOR LOOP RIMS AND CONNECT TO NEW LOOP ASSEMBLIES.

DATE	BY	DESCRIPTION

REVISIONS

DATE BY DESCRIPTION

JOSE A. OJEDA, P.E.
 4001 SW 15th Avenue, Suite 200
 Miami, Florida 33135
 Phone: (305) 676-2320
 Fax: (305) 676-2320
 Caddres of Professional No. 7194

PROJECT: CITY OF DORAL
 3026 ROADWAY RESURFACING PROJECT

SEGMENT 2
 NW 112 AV.
 FROM NW 82 ST. TO NW 86 ST.

SHEET NO. 5

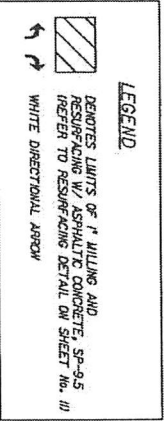
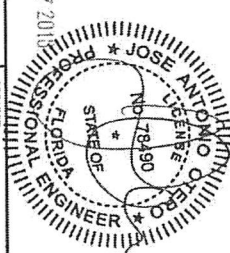

APPROX. MILLING AND RESURFACING
AREA = 3,280 SQ. FT.

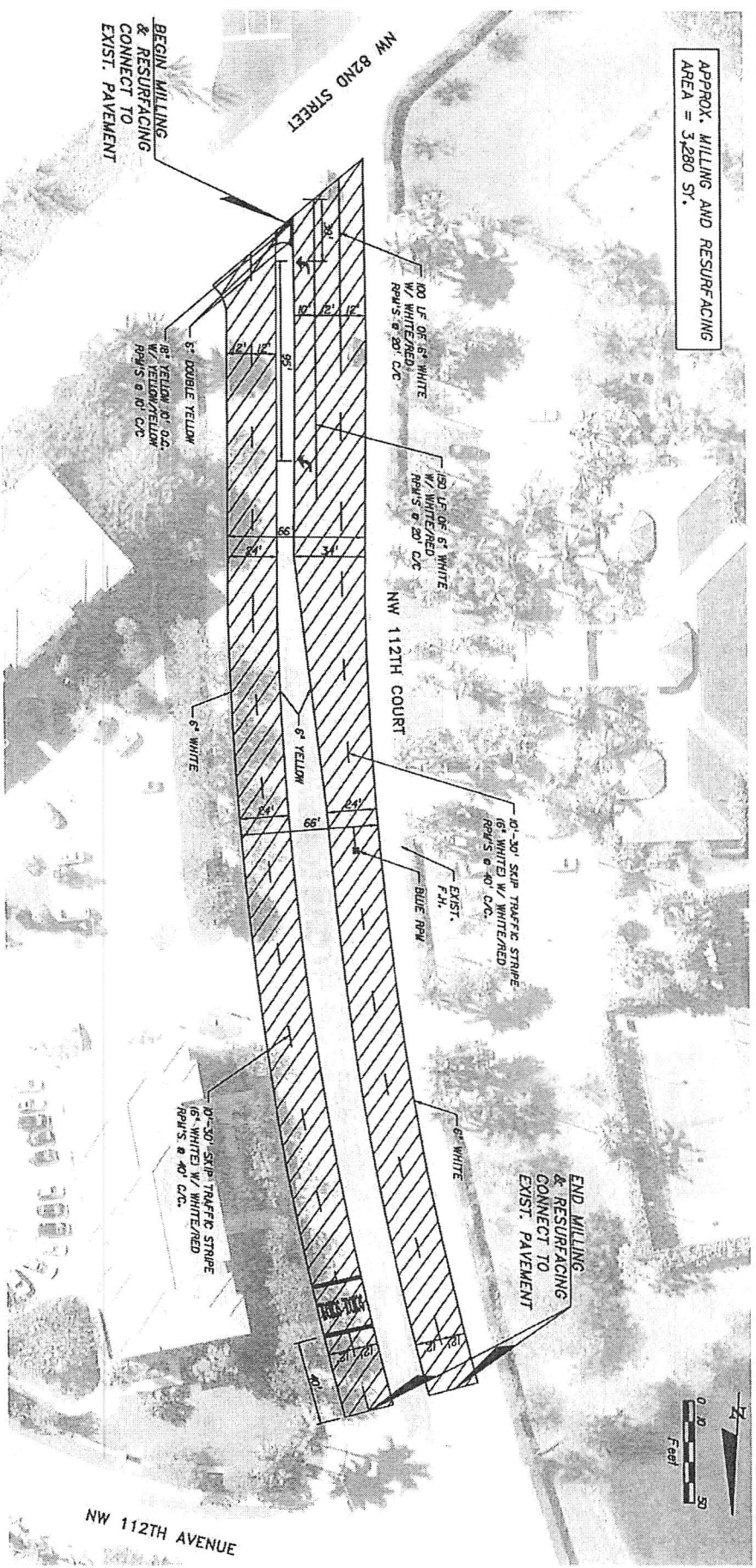

- NOTES**
1. CONTRACTOR SHALL NOTIFY ADJACENT PROPERTY OWNERS PRIOR TO COMMENCEMENT OF WORK.
 2. AN APPROVED M.O.T. PLAN SHALL BE REQUIRED ANYTIME WORK IS BEING PERFORMED AND SHOULD CONFORM TO THE LATEST EDITION AS REQUIRED BY THE CITY OF DORAL.
 3. CONTRACTOR SHALL INSTALL REFLECTIVE PAVEMENT MARKERS IN ACCORDANCE WITH FOOT INDEX NO. 7352.
 4. CONTRACTOR SHALL LOCATE FULL BOXES FOR LOOP RIMS AND CONNECT TO NEW LOOP ASSEMBLIES.

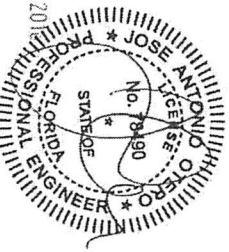

AUG 17 2011

LEGEND

- DENOTES LIMITS OF MILLING AND RESURFACING W/ ASPHALTIC CONCRETE, SP-9.5 (REFER TO RESURFACING DETAIL ON SHEET No. 11)
- WHITE DIRECTIONAL ARROW



DATE	BY	DESCRIPTION
		REVISED
		DATE
		BY
		DESCRIPTION
<p>Project: CITY OF DORAL 3012 ROADWAY RESURFACING PROJECT</p> <p>Segment: 3 NW 112 CT. FROM NW 82 ST. TO NW 112 AV.</p>		
SHEET NO.		7

John A. Otero, P.E.
 Board No. 11400
 5401 SW 75th Avenue, Suite 200
 Miami, Florida 33170
 Phone: (305) 670-2200
 Fax: (305) 670-2201
 Databases & Administration No. 7184
 Engineering

APPROX. MILLING AND RESURFACING
AREA = 2,949 ST.

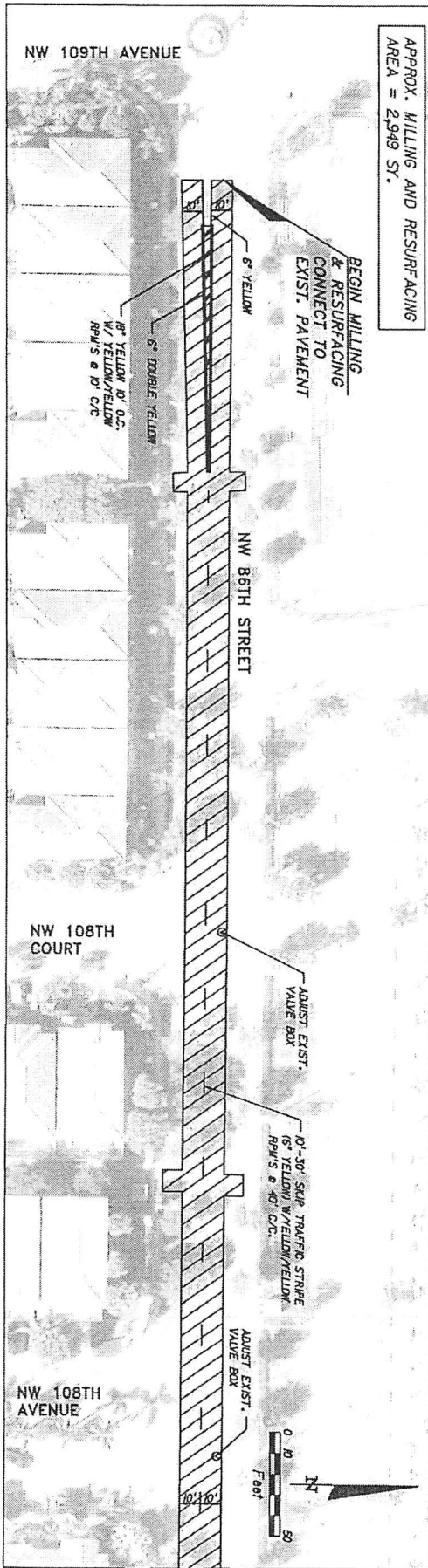

MATCH LINE SEE BELOW

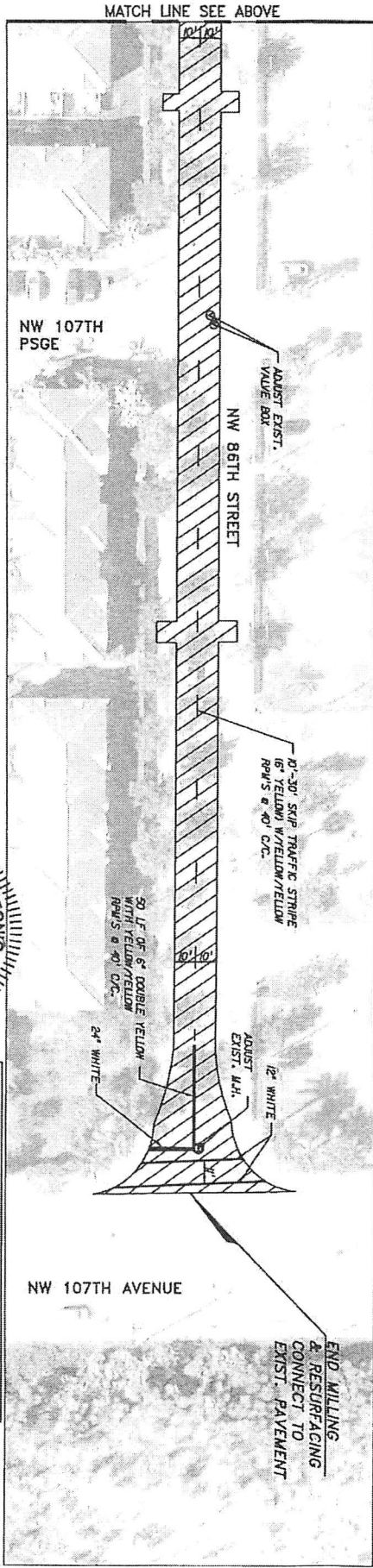

- NOTES**
1. CONTRACTOR SHALL NOTIFY ADJACENT PROPERTY OWNERS PRIOR TO COMMENCEMENT OF WORK.
 2. ALL APPROVED M.O.T. PLAN SHALL BE REQUIRED ANYTIME WORK IS BEING PERFORMED AND SHALL CONFORM TO THE LATEST EDITION OF THE FOOT DESIGN STANDARDS 600 SERIES AND THE MUTCD.
 3. CONTRACTOR SHALL FIELD VERIFY ALL PAVEMENT WIDTHS BEFORE COMMENCEMENT WORK.
 4. CONTRACTOR SHALL INSTALL REFLECTIVE PAVEMENT MARKERS IN ACCORDANCE WITH FOOT INDEX NO. 17358.
 5. CONTRACTOR SHALL LOCATE PULL BOXES FOR LOOP RIMS AND CONNECT TO NEW LOOP ASSEMBLIES.

DATE	BY	DESCRIPTION

Paul A. Otero, P.E.
 Prolife License No. 78460
 5801 NW 87th Avenue, Suite 200
 Miami, Florida 33173
 Phone: (305) 970-2320
 Fax: (305) 970-2320
 Certificate of Authorization No. 7184

PROJECT: CITY OF DORAL
 2016 ROADWAY RESURFACING PROJECT

SEGMENT 4
 NW 86 ST.
 FROM NW 107 AV. TO NW 109 AV.

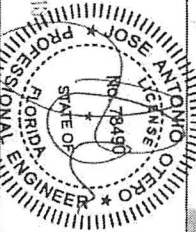

LEGEND

- ▨ DENOTES LIMITS OF MILLING AND RESURFACING W/ ASPHALTIC CONCRETE, SP-9.5 REFER TO RESURFACING DETAIL ON SHEET NO. 111
- ↔ WHITE DIRECTIONAL ARROW



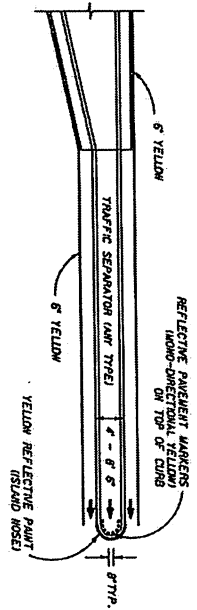

DETAIL 1

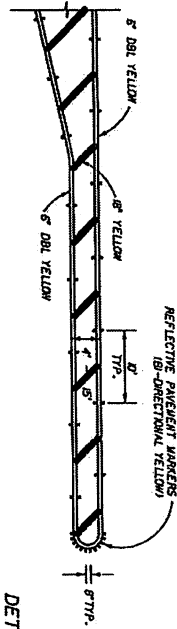

DETAIL 2

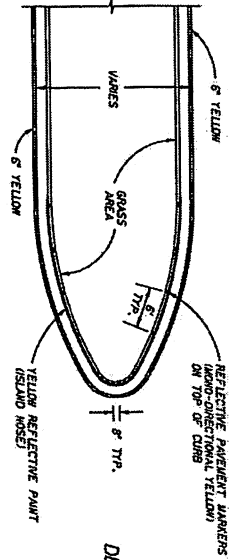

DETAIL 3

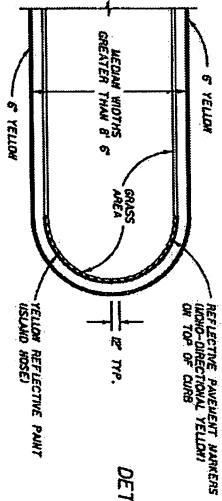

DETAIL 4

TYPICAL PLACEMENT OF REFLECTIVE PAVEMENT MARKERS (RPM'S)

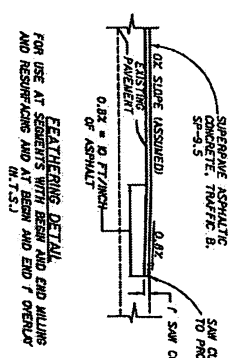
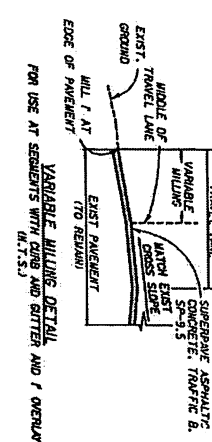
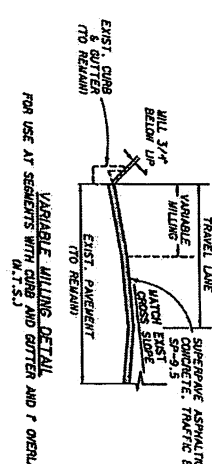

RESURFACING DETAIL

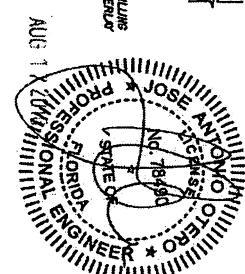

DATE	BY	DESCRIPTION	REVISIONS	DATE	BY	DESCRIPTION

John A. Otero, P.E. Florida License No. 78490 9401 SW 15th Avenue, Suite 200 Miami, FL 33150 Phone: (305) 870-2250 Fax: (305) 870-2251 Certificate of Authorization No. 714	PRODUCTS CITY OF DORAL 2016 ROADWAY RESURFACING PROJECT	MISCELLANEOUS DETAILS	SHEET NO. 11
---	--	-----------------------	-----------------